



FEATURES:



7 Occupancy



3 Bedroom



2 Bathroom



1 Car Parking



Dish Washer



Strict NO Party Policy



Strict NO Pets Accepted



Linen Included



Washing Machine

ABOUT THIS PROPERTY

This modern 3 bedroom property, boasts a centrally located kitchen with state of the art appliances, large open living and dining areas with plenty of room for the family to rest and play making it ideal for your holiday! With all living areas situated on the first floor this property has stunning views of the surrounding reserve, you would be forgiven for feeling like the only people left in the world!

KITCHEN & COOKING FACILITIES

Fully equipped kitchen with stainless steel appliances, electric stovetop, oven, fridge freezer and dishwasher.

BEDROOMS & BEDDING CONFIGURATION

The property comfortably sleeps 7 people, in the following bedding configuration:

Bedroom 1-Ground level- 1 x Queen bed, with ensuite

Bedroom 2- Ground level-1 x Tri-bunk

Bedroom 3- 3rd level- 1 Queen bed

BATHROOMS

Bathroom 1- ground level- spa bath with shower over bath

Bathroom 2- ground level- ensuite to bedroom 2 with shower

HEATING & COOLING FACILITIES

Gas fire and electric panel heating

LAUNDRY DETAILS

Washing machine and dryer

small drying room

ENTERTAINMENT FACILITIES

TV, DVD, kids DVD's

Krystal Peaks

11 Roney Macs Twist, Dinner Plain

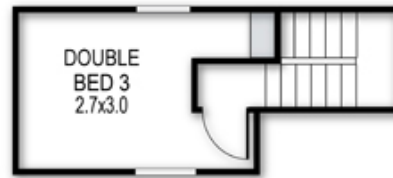

SECOND FLOOR



GROUND FLOOR

archistyle

Whilst every attempt has been made to ensure the accuracy of this floorplan, measurements of doors, windows, rooms and any other items are approximate only. The producer or the agent cannot be held responsible for any errors, omissions or misstatements. This plan is for illustrative purposes only and should be used as such.

